



TEXAS WOMAN'S
UNIVERSITY™

STUDENT UNION AT HUBBARD HALL

2025-2026 COMMUNITY EVENT
PRICING GUIDE



SOUTHWEST BALLROOM

CAPACITIES

Banquet Style: 640
Theater Style: 1,000
Expo: 90 tables

ROOM SPECS

11,852 Square Feet
17' Ceiling Height

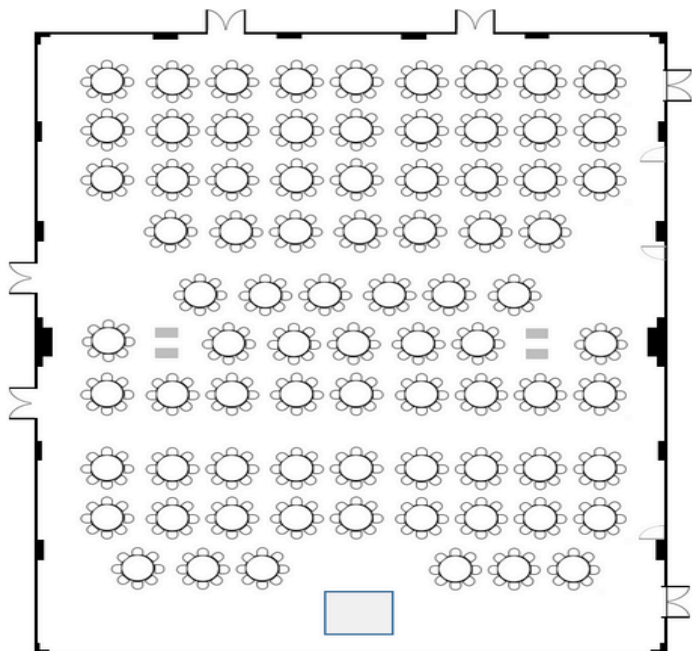

RENTAL

Facility Usage Rate:

\$2,000 (M- Th)

\$3,000 (F-S)

Includes 4 hours of room rental.

Additional Hourly Rental: \$100

EVENT TECHNOLOGY

Full Audio/Visual Package: \$600

Includes microphone package, screens, projectors, PC usage

Microphone Package: \$100

Includes wireless handheld microphones, house sound system

Camera Package: \$200 + On-Site Tech

Set up of mobile camera equipment for recording of event. Live streaming through a custom link can be added for \$75.

***This room is NOT equipped for web conferencing (Zoom)*

Column Lights: \$300

Colored accent lights throughout the room.

Dynamic Lighting: \$300 + On-Site Tech

Ceiling-mounted moving lights in choice of color and standard image.

Custom Gobo Image: \$300

A custom image will be created to be used in the dynamic lights. Examples include: company logo, monogram, etc.

View the Event Equipment page for a list of additional furniture, services and enhancements that can be added to your event.

SOUTHWEST BALLROOM - SIDE A

CAPACITIES

Banquet Style: 304
Theater Style: 456
Classroom Style: 236
Expo: 51 tables

ROOM SPECS

5,918 Square Feet
17' Ceiling Height

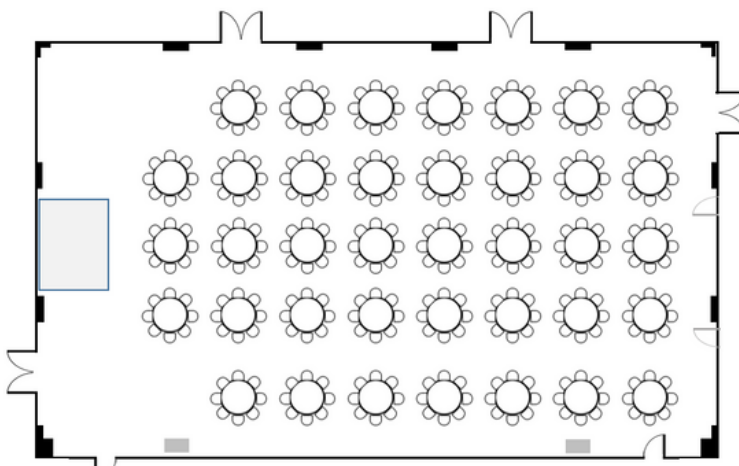

RENTAL

Facility Usage Rate:

\$1,400 (M- Th)

\$1,820 (F-S)

Includes 4 hours of room rental.

Additional Hourly Rental: \$100

EVENT TECHNOLOGY

Full Audio/Visual Package: \$300

Includes microphone package, screens, projectors, PC usage

Microphone Package: \$100

Includes wireless handheld microphones, house sound system

Camera Package: \$200+ On-Site Tech

Set up of mobile camera equipment for recording of event. Live streaming through a custom link can be added for \$75.

***This room is NOT equipped for web conferencing (Zoom)*

Column Lights: \$150

Colored accent lights throughout the room.

Dynamic Lighting: \$150 + On-Site Tech

Ceiling-mounted moving lights in choice of color and standard image.

Custom Gobo Image: \$300

A custom image will be created to be used in the dynamic lights. Examples include: company logo, monogram, etc.

View the Event Equipment page for a list of additional furniture, services and enhancements that can be added to your event.

SOUTHWEST BALLROOM - SIDE B

CAPACITIES

Banquet Style: 288
Theater Style: 490
Classroom Style: 236
Expo: 55 tables

ROOM SPECS

5,918 Square Feet
17' Ceiling Height



Chairs in image were rented from an external event company.

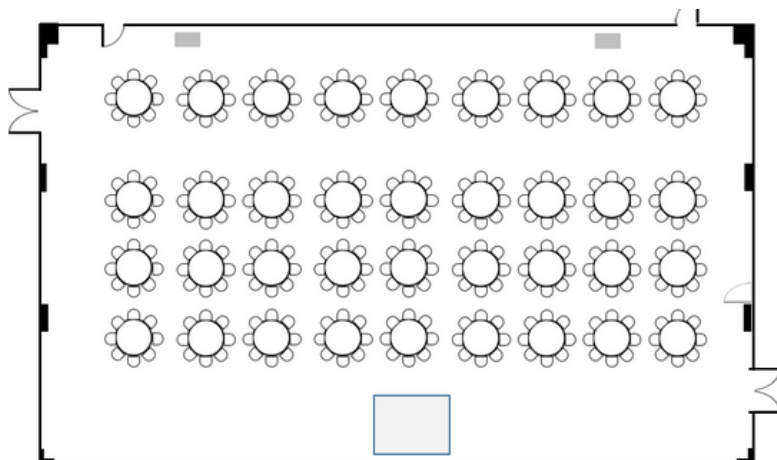

RENTAL

Facility Usage Rate:

\$1,400 (M- Th)

\$1,820 (F-S)

Includes 4 hours of room rental.

Additional Hourly Rental: \$100

EVENT TECHNOLOGY

Full Audio/Visual Package: \$300

Includes microphone package, screens, projectors, PC usage

Microphone Package: \$100

Includes wireless handheld microphones, house sound system

Camera Package: \$200+ On-Site Tech

Set up of mobile camera equipment for recording of event. Live streaming through a custom link can be added for \$75.

***This room is NOT equipped for web conferencing (Zoom)*

Column Lights: \$150

Colored accent lights throughout the room.

Dynamic Lighting: \$150 + On-Site Tech

Ceiling-mounted moving lights in choice of color and standard image.

Custom Gobo Image: \$300

A custom image will be created to be used in the dynamic lights. Examples include: company logo, monogram, etc.

View the Event Equipment page for a list of additional furniture, services and enhancements that can be added to your event.

SOUTHEAST BALLROOM

CAPACITIES

Banquet Style: 160
Theater Style: 200
Reception: 112
Expo: 37 tables

ROOM SPECS

3,165 Square Feet
17' Ceiling Height

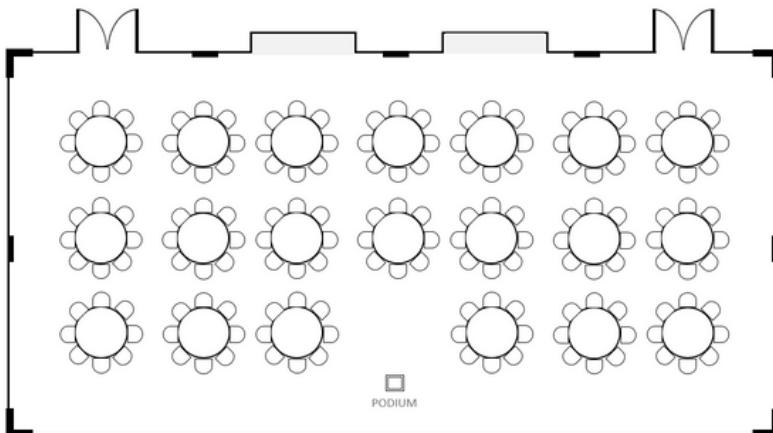

RENTAL

Facility Usage Rate:

\$1,000 (M- Th)

\$1,300 (F-S)

Includes 4 hours of room rental.

Additional Hourly Rental: \$100

EVENT TECHNOLOGY

Full Audio/Visual Package: \$300

Includes microphone package, screens, projectors, PC usage

Microphone Package: \$100

Includes wireless handheld microphones, house sound system

Camera Package: \$200+ On-Site Tech

Set up of mobile camera equipment for recording of event. Live streaming through a custom link can be added for \$75.

***This room is NOT equipped for web conferencing (Zoom)*

Column Lights: \$150

Colored accent lights throughout the room.

Dynamic Lighting: \$150 + On-Site Tech

Ceiling-mounted moving lights in choice of color and standard image.

Custom Gobo Image: \$300

A custom image will be created to be used in the dynamic lights. Examples include: company logo, monogram, etc.

View the Event Equipment page for a list of additional furniture, services and enhancements that can be added to your event.

BRIDGES AUDITORIUM

CAPACITY

Theater Style: 295
*Additional 5 spaces for
wheelchair on front row.*

ROOM SPECS

All chairs are equipped
with outlets and tablet
desks.

RENTAL

Facility Usage Rate:

\$895 (M- Th)

\$1,000 (F-S)

Includes 4 hours of room rental.

Additional Hourly Rental: \$100

EVENT TECHNOLOGY

Full Audio/Visual Package: \$150

Includes video wall, wireless
microphones, sound system, PC usage

Camera Package: \$100 + On-Site Tech

Use of built in camera equipment for web
conferencing (Zoom) or recording of event.
Live streaming through a custom link can
be added for \$75.



**View the Event Equipment page for a list
of additional furniture, services and
enhancements that can be added to your
event.**

SGA CHAMBERS

CAPACITY

Classroom Style: 38



RENTAL

Facility Usage Rate:

\$895 (M- Th)

\$1,000 (F-S)

Includes 4 hours of room rental.

Additional Hourly Rental: \$100

EVENT TECHNOLOGY

Full Audio/Visual Package: Included with room rental

Includes video wall, wireless microphones, sound system, PC usage

Camera Package: \$100 + On-Site Tech

Use of built in camera equipment for web conferencing (Zoom) or recording of event. Live streaming through a custom link can be added for \$75.



View the Event Equipment page for a list of additional furniture, services and enhancements that can be added to your event.

PERFORMANCE CENTER

CAPACITY

Expo: 18 tables

Other: Varies

RENTAL

Facility Usage Rate:

\$770 (M- Th)

\$845 (F-S)

Includes 4 hours of room rental.

Additional Hourly Rental: \$75

Single Vendor Table: \$75

Individual vendor tables are available without rental of the entire space.

Additional Vendor Table: \$50

The Performance Center is an open stage on the first floor of the Union. It's proximity to the game room and retail dining area make it the ideal location to interact with students passing through the building. Vendor fairs, information tables, and performances are common event types that take place in this area.

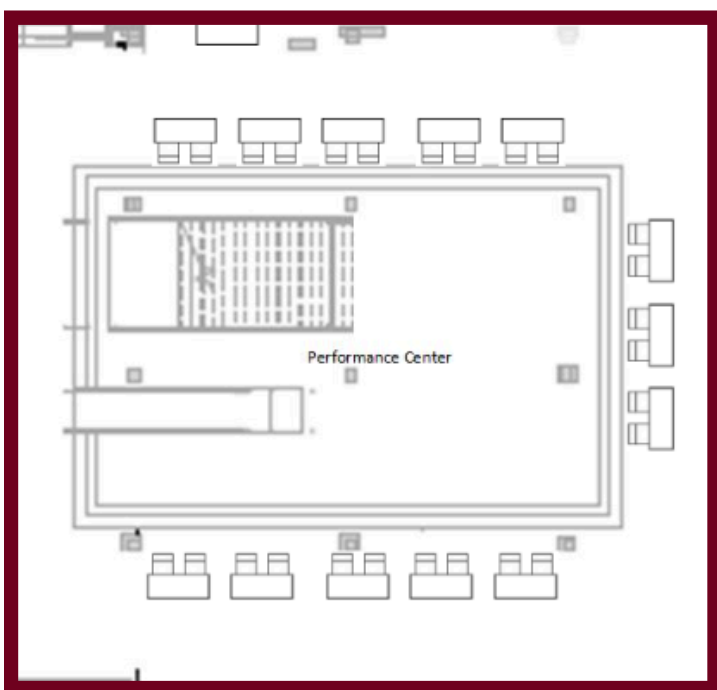

View the Event Equipment page for a list of additional furniture, services and enhancements that can be added to your event.

MEETING ROOM 2231

CAPACITIES

Banquet Style: 64
Theater Style: 100
Classroom Style: 48

ROOM SPECS

1,414 Square Feet
8" Ceiling Height

RENTAL

Facility Usage Rate: \$275
Includes 4 hours of room rental.

Additional Hourly Rental: \$50

EVENT TECHNOLOGY

Projector Package: \$100
Includes screens, projectors, PC usage

Camera Package: \$200 + On-Site Tech
Set up of mobile camera equipment for recording of event. Live streaming through a custom link can be added for \$75.

***This room is NOT equipped for web conferencing (Zoom)*

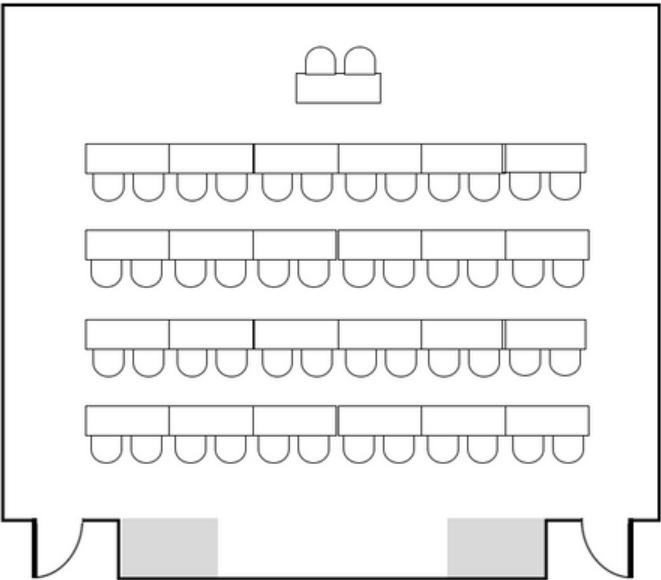

View the Event Equipment page for a list of additional furniture, services and enhancements that can be added to your event.

PRE-SET MEETING ROOMS

Pre-set meeting rooms are equipped with modular furniture that groups may rearrange to suit their needs. Access to the built in TV monitor and web camera is included with the rental, however these rooms do not contain computers. Groups may chose to provide their own computer or rent a laptop from the Student Union if available (see the à la carte technology list for pricing).

Meeting Room 1200

RENTAL

Facility Usage Rate: \$100

Includes 4 hours of room rental, use of TV monitor and web camera.

Additional Hourly Rental: \$25

CAPACITY

Hollow Square: 20



Meeting Room 1602

RENTAL

Facility Usage Rate: \$100

Includes 4 hours of room rental, use of TV monitor and web camera.

Additional Hourly Rental: \$25

CAPACITY

Theater Style: 35



PRE-SET MEETING ROOMS

Meeting Room 2238

RENTAL

Facility Usage Rate: \$100

Includes 4 hours of room rental.

Additional Hourly Rental: \$25

CAPACITY

Hollow Square: 20



CONFERENCE ROOMS

Conference rooms include fixed conference seating for small meetings. Access to the built in TV monitors is included with the rental, however these rooms do not contain computers. Groups may chose to provide their own computer or rent a laptop from the Student Union if available (see the à la carte technology list for pricing).

Conference Rooms 2211, 2213, 2213

RENTAL (per room)

Facility Usage Rate: \$50

Includes 4 hours of room rental.

Additional Hourly Rental: \$10

CAPACITY

Conference Style: 6



EVENT EQUIPMENT

Tables & Chairs

60" Round Tables: \$8

Linens rented through Chartwells

6' Rectangle Table: \$6

Linens rented through Chartwells

6' Black Table Drape: \$12

Used for check in tables, etc.

5' Meeting Room Table: \$6

Cocktail Table: \$10

Black Cocktail Table Linen: \$12

Banquet Chair: \$1

Cost of 60" round tables, 6' rectangle tables and chairs waived for events with catering.

There is no cost for equipment used in pre-set meeting rooms.



Specialty Equipment

Dance Floor: \$1,000

Easel: \$10

Stage Riser (4' x 8'): \$28

Podium (Wooden or Acrylic): \$50

Podium (Light Up): \$100

Stanchions: \$15

Pipe & Drape Sections: \$25

Rolling Dry Erase Board: \$25

Temporary Storage Cage: \$20/night



Chivari chairs rented from external event company.

EVENT EQUIPMENT

À la Carte Technology

On-Site Technician: \$50/hour

Portable Uplights (6): \$100

Choice of color; can be used in any room

Portable Uplights (12): \$200

Choice of color; can be used in any room

Spotlight : \$100 + on-site tech

Portable Sound System: \$75

Concert Series Sound Package: contact for custom quote

Laptop: \$100

Available for use in meeting rooms where a computer is not included in the A/V package.



EVENT SERVICES

Catering

Pioneer Catering (Chartwells) is the exclusive food service provider for the Student Union at Hubbard Hall (including alcohol service). Contact Chartwells for menu options and pricing (940) 898-2781.

Parking

Parking is available at no cost on weekends and for a fee during the week. Your coordinator will create a custom parking quote based on your specific event details. Pricing is set by TWU's Parking Office.

Security

Events with greater than 100 guests and alcohol services will be reviewed by the Special Events Committee for security assignment. Please review TWU's Special Events Policy for additional information.

Vendors

With the exception of catering (all food and beverages), you are welcome to use your choice of vendor, though all services must be approved by the Student Union Office. Visit www.discoverdenton.com for a selection of local event companies.



BUILDING MAP

1st Floor

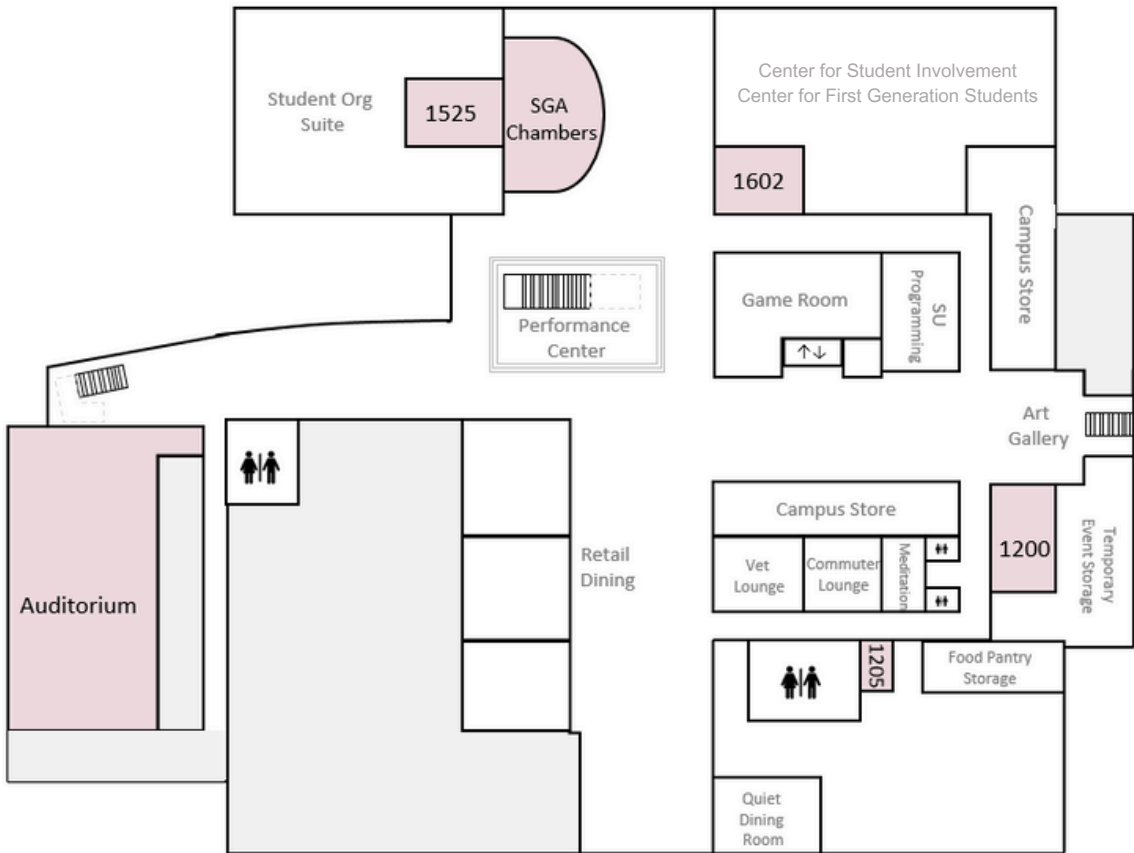

2nd Floor

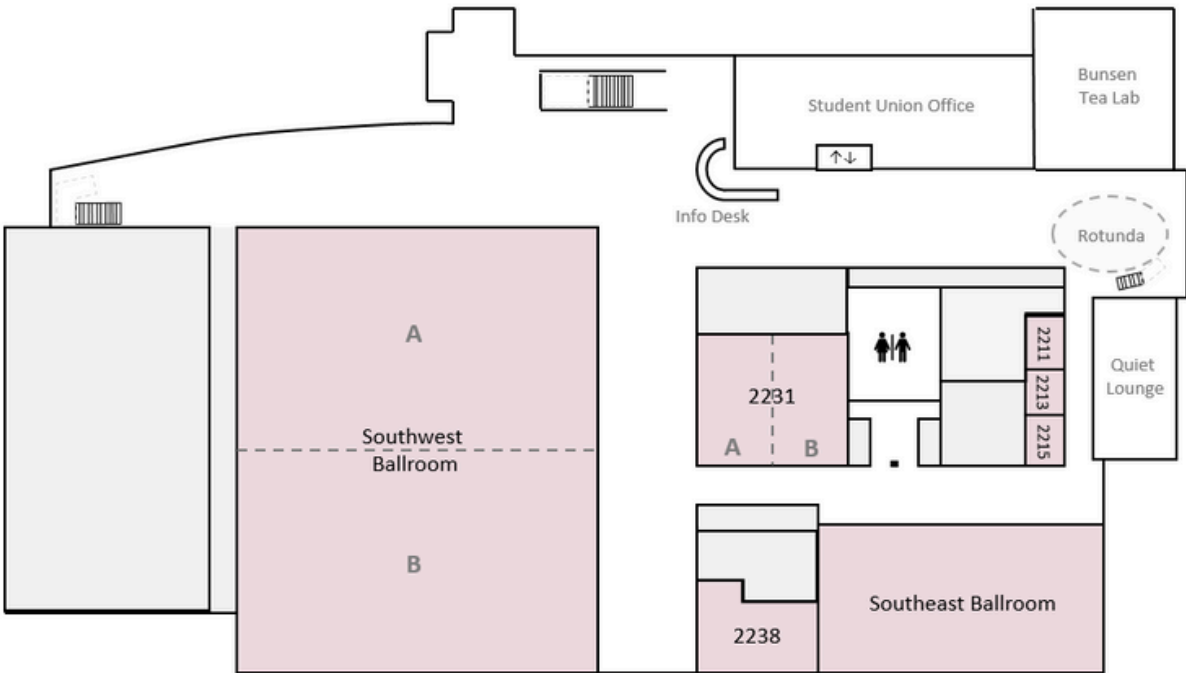

LOCATION

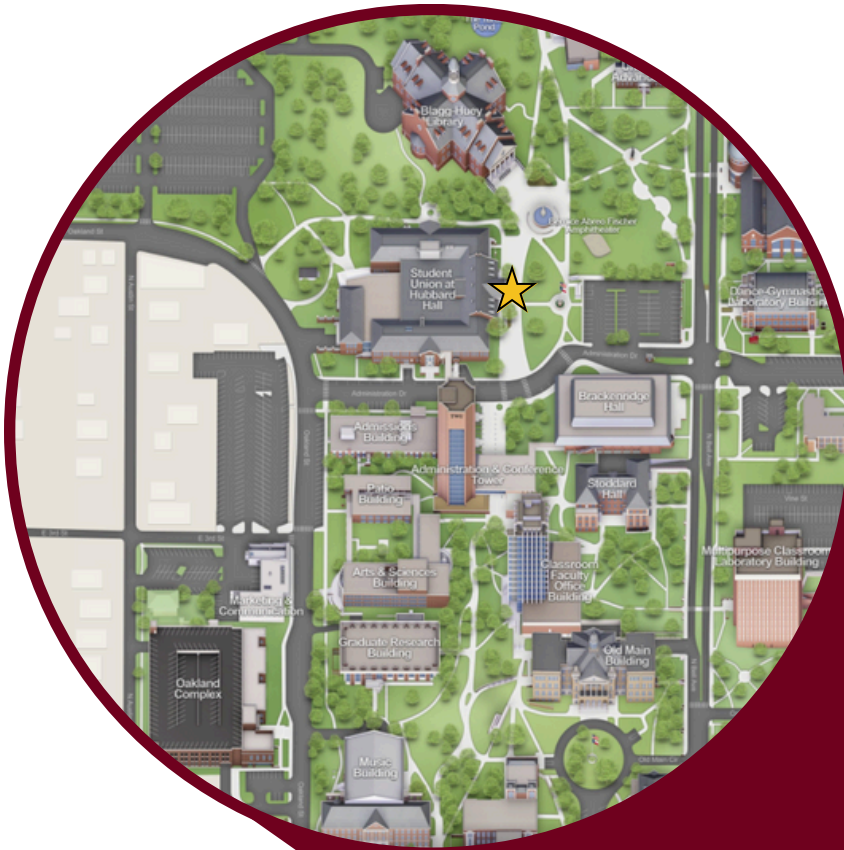

**Texas Woman's University
Student Union at Hubbard Hall
301 Administration Drive
Denton, TX 76201**

